



User Manual

EM60

Directory

Directory	II
1 Picture	III
2 Table	IV
3 Safety Instruction	1
4 Overview	2
4.1 Overview	2
4.2 Packing Contents	3
5 Introduction to the User	6
5.1 Instruction of Keypad and Interface	6
5.2 Introduction of EXT icons	错误！未定义书签。
5.3 EXT Installation	6
5.4 WEB Configuration	8
6 DSS Key	10
6.1 DSS Key	13
6.1.1 DSS Key Configuration	13
6.1.2 DSS Key Configuration	13
6.2 DSS Key Steps	18
6.2.1 Web Configurations	18
6.2.2 Memory key Configurations	19
6.2.3 Line Configurations	19
6.2.4 Key Event Configurations	20
6.2.5 DTMF Configurations	21
6.2.6 URL/Action URL/XML Browser Configurations	22
6.2.7 MCAST Configurations	22
7 Firmware Upgrade	24
8 Reboot Phone	25
9 Common Trouble Cases	26
9.1 Device could not boot up	26
9.2 Connection failure	26
9.3 Factory Reset	26

1 Picture

Picture 1	- Instruction of Keypad and Interface	6
Picture 2	- Connect the EXT	7
Picture 3	- Connect two EXT	7
Picture 4	- Connect Power	7
Picture 5	- Connect USB cable/power	8
Picture 6	- Mounting Bracket	8
Picture 7	- WEB Connection Status	9
Picture 8	- Backlight	11
Picture 9	- Power Saving	11
Picture 10	- Display Configuration	12
Picture 11	- Phone Dss key	13
Picture 12	- EXT Key (1)	18
Picture 13	- EXT Key (2)	19
Picture 14	- EXT Key (3)	20
Picture 15	- EXT Key (4)	21
Picture 16	- EXT Key (5)	21
Picture 17	- EXT Key (6)	22
Picture 18	- EXT Key (7)	23
Picture 19	- EXT Firmware Upgrade	24
Picture 20	- Reboot Phone	25

2 Table

Table 1	- EXT icons	错误！未定义书签。
Table 2	- Backlight Settings	10
Table 3	- Display Configuration	11
Table 4	- DSS key	15
Table 5	- Key Event LED status	17

3 Safety Instruction

Please read the following safety notices before installing or using this unit. They are crucial for the safe and reliable operation of the device.

- Please use the external power supply that is included in the package. Other power supply may cause damage to the phone and affect the behavior or induce noise.
- Before using the external power supply in the package, please check the home power voltage. Inaccurate power voltage may cause fire and damage.
- Please do not damage the power cord. If power cord or plug is impaired, do not use it because it may cause fire or electric shock.
- Do not drop, knock or shake the phone. Rough handling can break internal circuit boards.
- This phone is designed for indoor use. Do not install the device in places where there is direct sunlight. Also do not put the device on carpets or cushions. It may cause fire or breakdown.
- Avoid exposure the phone to high temperature or below 0°C or high humidity.
- Avoid wetting the unit with any liquid.
- Do not attempt to open it. Non-expert handling of the device could damage it. Consult your authorized dealer for help, or else it may cause fire, electric shock and breakdown.
- Do not use harsh chemicals, cleaning solvents, or strong detergents to clean it. Wipe it with a soft cloth that has been slightly dampened in a mild soap and water solution.
- When lightning, do not touch power plug, it may cause an electric shock.
- Do not install this phone in an ill-ventilated place. You are in a situation that could cause bodily injury. Before you work on any equipment, be aware of the hazards involved with electrical circuitry and be familiar with standard practices for preventing accidents.

4 Overview

4.1 Overview

Thank you for choosing the Fanvil EM60 extension station. The EM60 is designed to provide a more effective and convenient office when using high-end phones such as V66/V66 Pro; the extension station can dynamically display the setting status of 20 DSS buttons per page, and supports 3 page turning. Each phone supports up to 4 EM60 cascading, a total of 240 DSS buttons that can be customized by the user, and the page-turning shortcut keys allow users to quickly switch to the specified page. Each DSS key can display green, red and yellow LED indicators to reflect the current state of the key.

Thank you for choosing the Fanvil EM60 extension station. The EM60 is designed to provide a more effective and convenient office when using high-end phones such as J6; the extension station can dynamically display the setting status of 20 DSS buttons per page, and supports 3 page turning. Each phone supports up to 4 EM60 cascading, a total of 240 DSS buttons that can be customized by the user, and the page-turning shortcut keys allow users to quickly switch to the specified page. Each DSS key can display green , red and yellow LED indicators to reflect the current state of the key.

In order to help some interested users better understand the details of the product, this user manual can be used as a reference guide for the use of the device. This document may not be applicable to the latest version of the software. If you have any questions, you can use the help prompt interface of the device phone, or download and update your user manual from the official website of the manufacturer.

4.2 Packing Contents

- Expansion Module

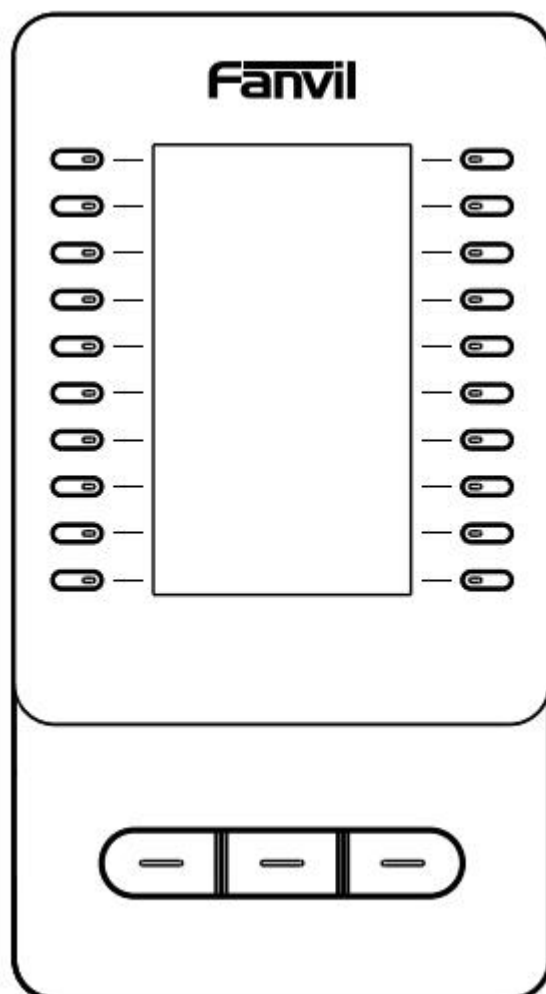

- Stand

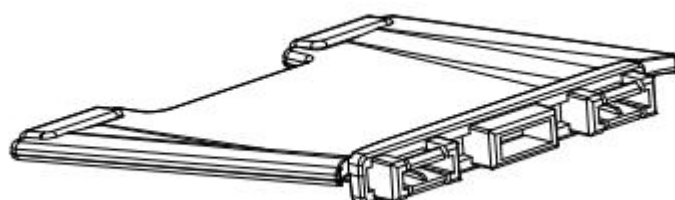

- Connecting Sheet

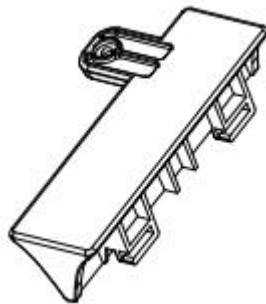

- Power Adapter

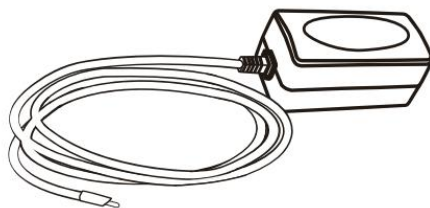

- USB Cable



- Screw



■ Quick Installation Guide

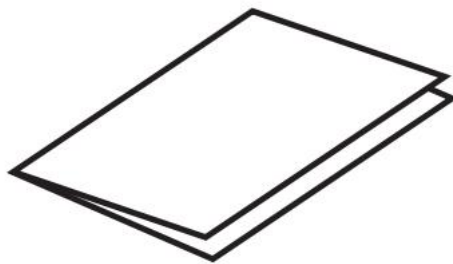

5 Introduction to the User

5.1 Instruction of Keypad and Interface

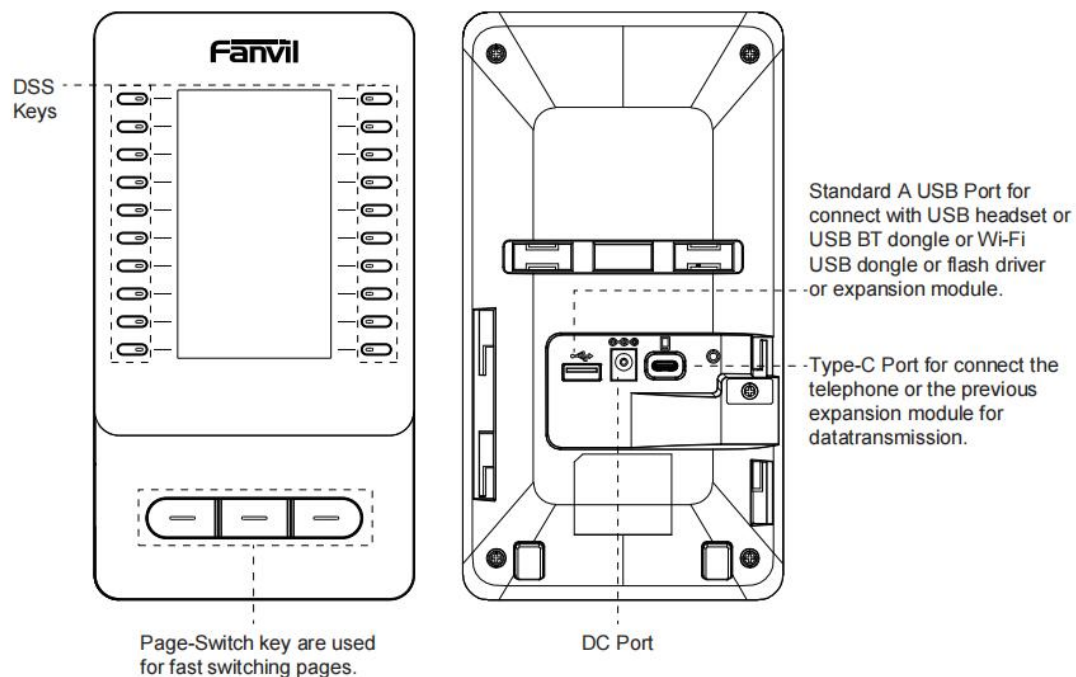

Picture 1 - Instruction of Keypad and Interface

The figure above shows the button layout of the expansion station. Each button provides its own specific function. The user can refer to the description of the buttons in the illustrations in this section to operate.

5.2 EXT Installation

Please follow the instructions in the picture below to install the device.

- Connection the device

When connecting a single expansion module:

As shown in the diagram below, use a USB cable to connect the expansion module to the telephone, as shown below:

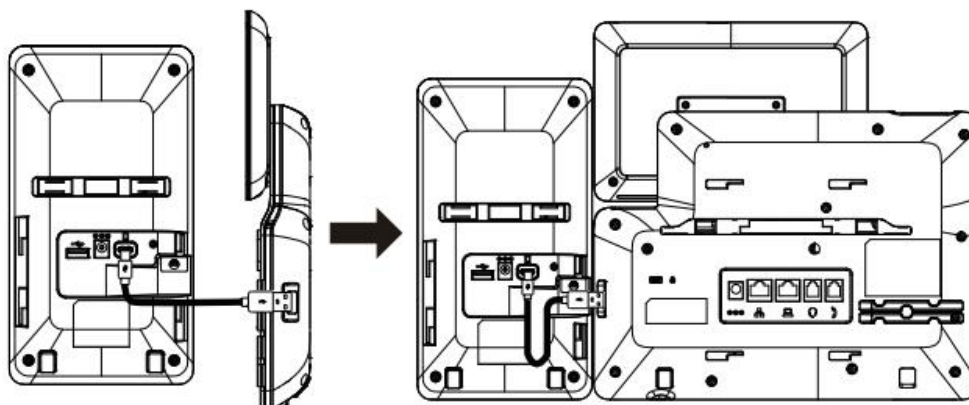

Picture 2 - Connect the EXT

- When connecting multiple expansion modules:

As shown in the diagram, install the connecting sheet onto one expansion module and secure it with the provided screw. Then attach the second expansion module to the opposite side.

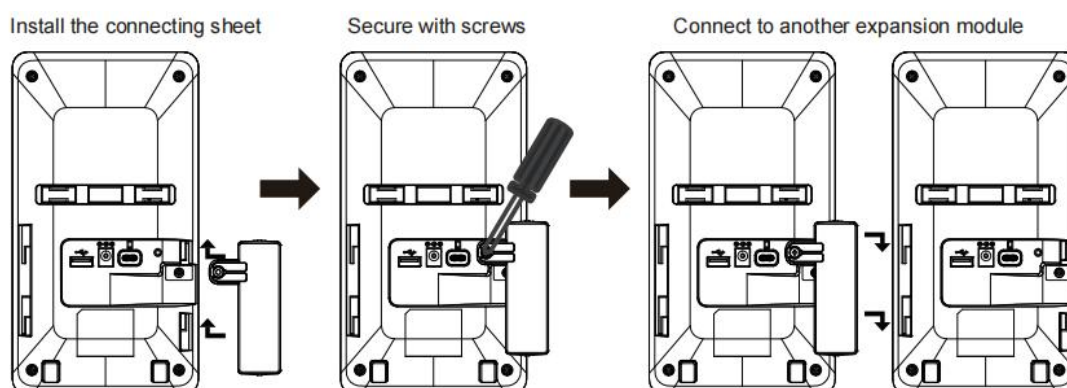

Picture 3 - Connect two EXT

Your phone and the two expansion modules are connected as shown below:

Note: This IP phone supports cascading up to 4 expansion modules. The connection rules for the power adapter (5V 1A) are as follows:

- When cascading 1-2 expansion modules: Connect the power adapter only to the last-stage expansion module.
- When cascading 3-4 expansion modules: Connect one power adapter to both the 2nd-stage and the last-stage expansion modules.

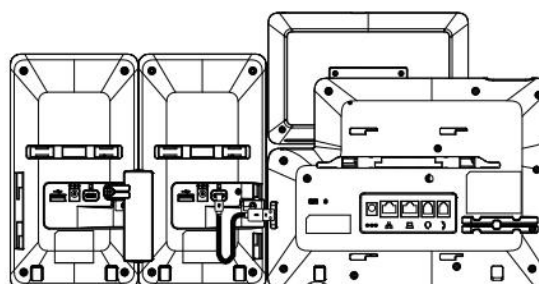

Picture 4 - Connect Power

Connecting the USB Cable:

Connect the USB port of the IP phone and the Type-C port of the first module using a USB cable. If you want to connect another module, connect the USB port of the first module and the Type-C port of the second module using a USB cable. And a power adapter is used to connect to the DC port of the previous expansion module to supply power for it. As shown below:

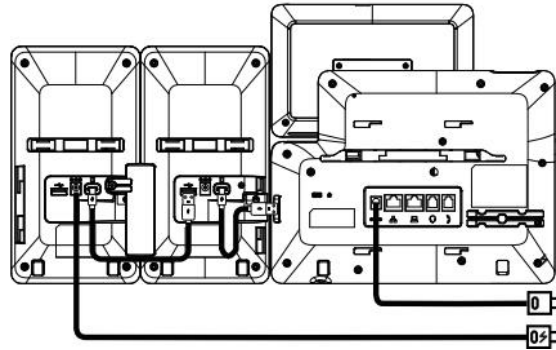

Picture 5 - Connect USB cable/power

● Desk Mount Method

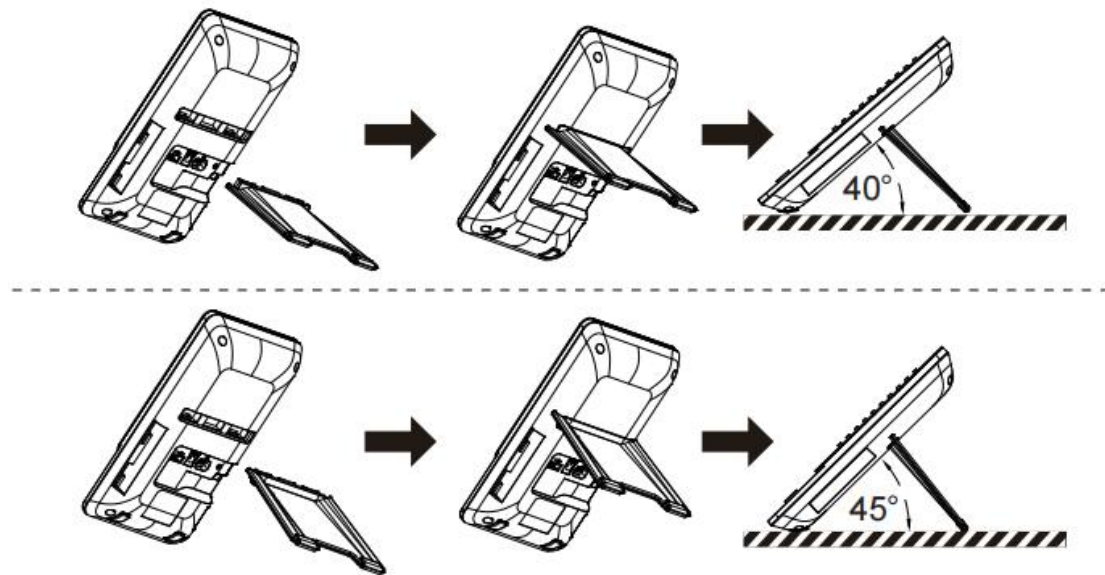

Picture 6 - Mounting Bracket

5.3 WEB Configuration

After the extension station is successfully connected, the webpage visits the Function Key> EXT key , and the serial numbers of all connected extension stations, as well as the corresponding extension station version and connection status will be displayed on the page. The status of the successfully connected extension station is **connected**.

System

Network

Line

Phone settings

Phonebook

Call logs

Function Key

Application

Security

Device Log

Function Key

Side Key

EXT Key

Softkey

Advanced

Firmware Upgrade

Select the expansion(s) to be upgraded:

<input type="checkbox"/>	Index	Version	Connection Status
<input type="checkbox"/>	1	0.0.0.6	Connected

Select File:

Select

Upload

Screen Configuration

Backlight Active Level:

15

(1~16)

Backlight Inactive Level:

5

(0~16)

Backlight Time:

Always On

Customer Backlight Time:

0

(1~54000)second(s)

Apply

Global Key Settings

Hide the dsskey Icon:

☐

Exkey Display Mode:

name + value

Apply

Expansion Settings ?

Picture 7 - WEB Connection Status

6 Expansion Board Settings

6.1 Backlight/Power Saving Settings

The expansion module supports setting the backlight brightness, which can be configured in **Function Key > EXT Key > Screen Configuration** to adjust the module's own brightness in use and idle brightness. The setting parameters are as follows:

Table 2 - Backlight Settings

Parameters	Description
Backlight Active Level	It is adjustable from Level 1 to Level 16, with a default brightness of Level 16.
Backlight Inactive Level	It is adjustable from Level 0 to Level 16, with a default brightness of Level 4.
Backlight Tim	It is adjustable to Always On / 15s / 30s / 1min / 2min / 5min / 10min / 30min / 1h / 2h / 3h / 6h / 15 / Custom, with a default setting of 1 minute.
Customer Backlight Time	It is adjustable from 1s to 54,000s, with a default setting of 60s

The expansion module supports an power saving mode. The configuration items for the power saving mode are consistent with those of the host's power saving settings, and the host side controls whether to enter hibernation through its configuration—no separate configuration item for EM60 will be added. The host's energy-saving mode can be controlled to enable both the host and the expansion module to enter hibernation simultaneously.

The adjustment location for the host's power saving mode is in **Phone Settings > Advanced > Screen Configuration**.

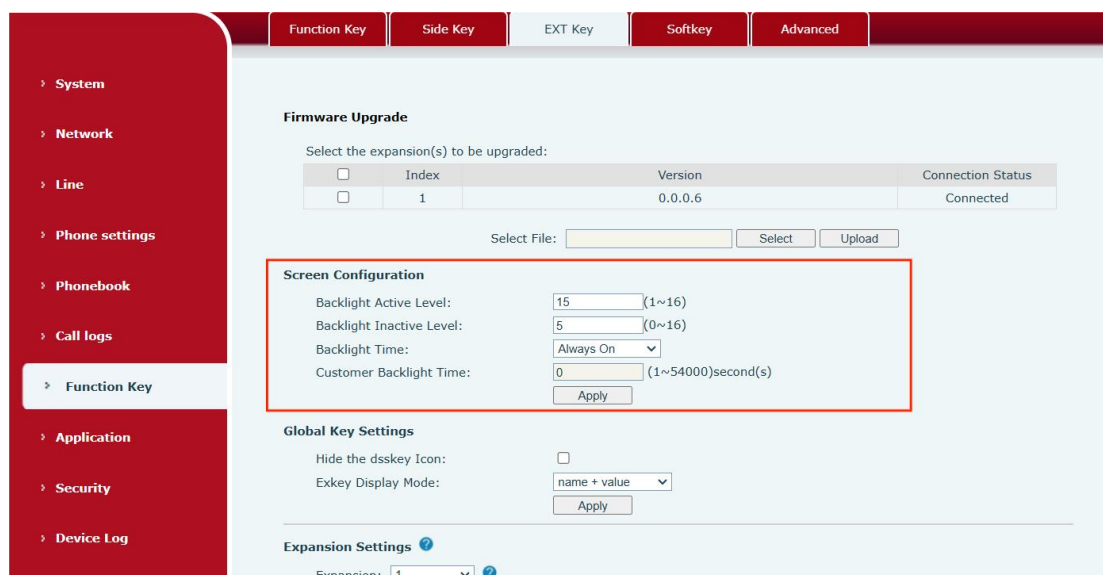

Picture 8 - Backlight

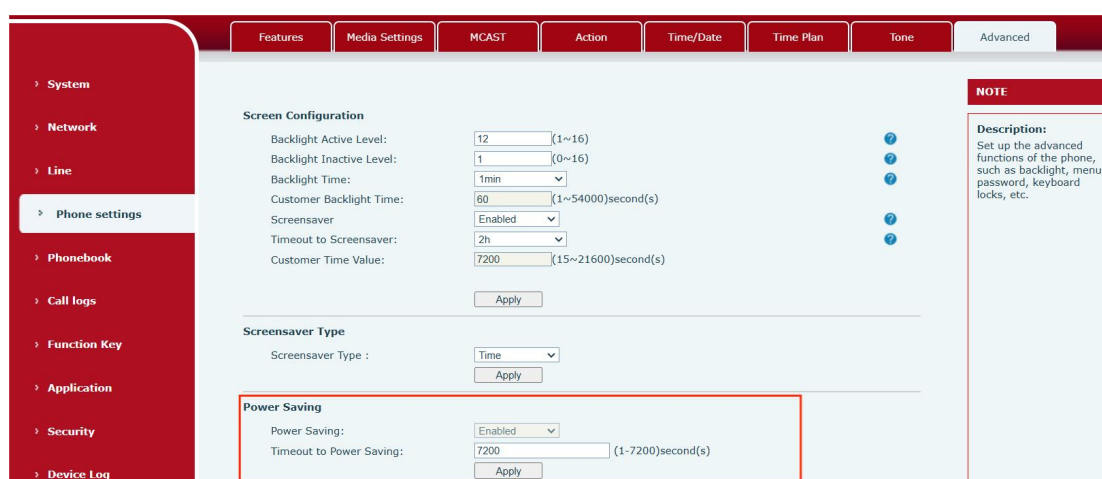

Picture 9 - Power Saving

6.2 Display Configuration

The expansion module supports display effect settings, which can be configured by accessing **Function Key > EXT Key > Global Key Settings**. The specific functions are as follows:

Table 3 - Display Configuration

Parameters	Description
Hide Dsskey Icon	After enabling this function, the Dsskey icons will be hidden, leaving only the text content displayed.
Exkey Display Mode	You can choose to display only the name, or display both the name and the value.

> System

> Network

> Line

> Phone settings

> Phonebook

> Call logs

> Function Key

> Application

> Security

> Device Log

Function Key

Side Key

EXT Key

Softkey

Advanced

Firmware Upgrade

Select the expansion(s) to be upgraded:

<input type="checkbox"/>	Index	Version	Connection Status
<input type="checkbox"/>	1	0.0.0.6	Connected

Select File:

Screen Configuration

Backlight Active Level: (1~16)

Backlight Inactive Level: (0~16)

Backlight Time:

Customer Backlight Time: (1~54000)second(s)

Global Key Settings

Hide the dsskey Icon: ☐

Exkey Display Mode:

Expansion Settings

Expansion:

Picture 10 - Display Configuration

7 DSS Key

7.1 DSS Key

Each page of the expansion table supports 20 DSS Keys, and 3 pages support a maximum of 60 DSS Keys. You can configure the DSS Key through the user interface of the phone, or configure the DSS Key through the web user interface.

The following sections explain in detail how to configure the DSS Key of the extension station through the web user interface and the phone LCD interface.

7.1.1 DSS Key Configuration

Press the unconfigured DSS Key of the extension station, or long press the configured DSS Key, the phone LCD will enter the corresponding configuration interface.

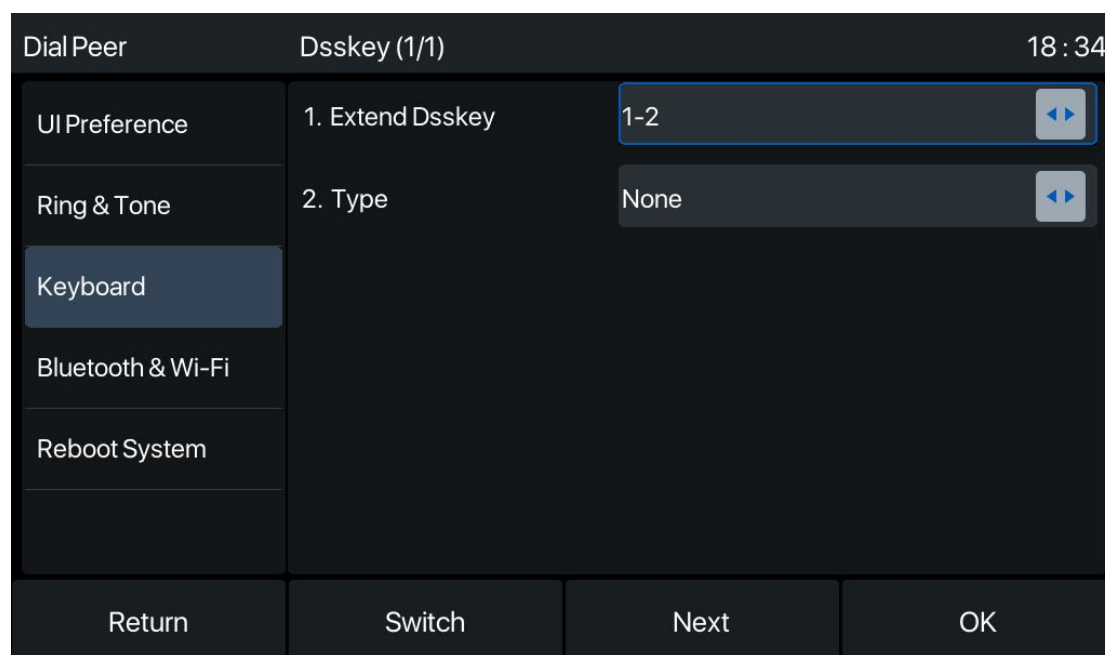

Picture 11 - Phone Dss key

7.1.2 DSS Key Configuration

Please press the downward navigation button on the phone to view the webpage IP address; Please open your browser and enter your IP address in the address bar (e.g. <http://192.168.1.1> or 192.168.1.1). The default username and password are both "admin".

The DSS key configuration includes:

- Memory key

- BLF/NEW CALL
- BLF/BXFER
- BLF/AFER
- BLF/CONF
- BLF/DTMF
- Presence
- Voice Mail
- Speed Dial
- Intercom
- Call Park
- Call forward
- Line
 - AUTO
 - SIP1/SIP2/SIP3...SIP19/SIP20/Moblie
- Key Event
 - Voice Mail
 - Do -not-disturb
 - Call hold
 - Call transfer
 - PhoneBook
 - Redail
 - Pick up
 - Join
 - Call forward
 - Call Logs
 - Flash
 - Memo
 - Headset
 - Release
 - Lock phone
 - SMS
 - Call Back
 - Hide DTMF
 - Intercom
 - Group Listening
 - Prefix
 - Hot Desking
 - Agent

- End
- Disposition
- Escalate
- Trance
- Handfree
- Answer Key
- Private Hold
- Local Contacts
- LDAP Group
- XML Group
- Broadsoft Group
- Record
- Auto Headset
- visual park
- DTMF
- URL
- BLF List
- MCAST Paging
- Action URL
 - http(s) Get
 - http(s) Post
- XML Browser
- MCAST Listening

The following table is the function description of each configuration item

Table 4 - DSS key

Parameters	Description
Memory Key	<p>BLF: It is used to prompt user the state of the subscribe extension, and it can also pick up the subscribed number, which help user monitor the state of subscribe extension (idle, ringing, a call). There are 3 types for one-touch BLF transfer method. p.s. User should enter the pick-up number for specific BLF key to fulfill the pick-up operation.</p> <p>Presence: Compared to BLF, the Presence is also able to view whether the</p>

	<p>user is online.</p> <p>Note: You cannot subscribe the same number for BLF and Presence at the same time</p> <p>Speed Dial: You can call the number directly which you set. This feature is convenient for you to dial the number which you frequently dialed.</p> <p>Intercom: This feature allows the operator or the secretary to connect the phone quickly; it is widely used in office environments.</p> <p>Voice Mail: Click to immediately dial out the corresponding voice mail access code.</p> <p>Call Park: Click to park the call on the server.</p> <p>Call Forwarding: When the phone receives an incoming call, you can click to quickly forward the number to the subscribed number.</p>
Line	It can be configured as a Line Key. User is able to make a call by pressing Line Key.
Key Event	<p>User can select a key event as a shortcut to trigger.</p> <p>For example: MWI / DND / Release / Headset / Hold / etc.</p>
DTMF	It allows user to dial or edit dial number easily.
URL	Open the specific URL directly.
BLF List	Subscribe to one BLF account group at a time
MCAST Paging	Configure the multicast address and voice codec. The user can initiate multicast by pressing this key
Action URL	The user can use a specific URL to make basic calls to the phone.

XML browser	Users can set the DSS Key for specific URL download and other operations.
MCAST Listening	Configure the multicast address and voice code, when the multicast is playing, press the button to manually monitor the multicast

The following table is a summary of the LED status of each function key.

Table 5 - Key Event LED status

Type	LED Light	State
Line Key	Off	Line inactive
	Green On	Line ready (Registered)
	Green Blinking	Ringing
	Red Blinking	Line is trying to register
	Red Blinking	Line error (Registration failure)
	Red On	Dialing/Line in use (Talking)
	Yellow Blinking	Call holding
BLF	Green On	Subscription number is idle.
	Red On	Subscription number is busy.
	Red Blinking	Subscription number is dialing.
	Off	Subscription number is unavailable.
Presence	Green On	Subscription number is idle.
	Red On	Subscription number is busy.
	Red Blinking	Subscription number is dialing.
	Off	Subscription number is unavailable.
DND	Red On	DND on

	Off	DND off
MWI	Green Blinking	New voice message
	Off	No New voice message
Page 1/2/3	green	The current page

7.2 DSS Key Steps

7.2.1 Web Configurations

1. When the extension station is not connected, the webpage visits Function Key > EXT key, and it prompts "No expansion module connected! Please connect one or more units then refresh this page."

2. You can choose each expansion station with serial number from 1 to 4.

Expansion station serial number: The first expansion station connected to the phone is serial number 1, and the others are 2, 3 and 4.

3. Select the page that needs to be configured for the corresponding expansion station.

An expansion station supports the configuration of 3 pages of shortcut keys.

4. Configure the submit key of the shortcut key, and the customized shortcut key configured after submission can take effect.

Function Key **Side Key** **EXT Key** **Softkey** **Advanced**

› System
› Network
› Line
› Phone settings
› Phonebook
› Call logs
› **Function Key**
› Application
› Security
› Device Log

Firmware Upgrade

Select the expansion(s) to be upgraded:

<input type="checkbox"/>	Index	Version	Connection Status
<input type="checkbox"/>	1	0.0.0.6	Connected

Select File:

Screen Configuration

Backlight Active Level: (1~16)
 Backlight Inactive Level: (0~16)
 Backlight Time:
 Customer Backlight Time: (1~54000)second(s)

Global Key Settings

Hide the dskey Icon: ☐
 Exkey Display Mode:

Expansion Settings ⓘ

Expansion: ⓘ

Picture 12 - EXT Key (1)

7.2.2 Memory key Configurations

The following steps are required:

1. Select **【Function key】** >> **【EXT Key】**
2. Select **【Memory key】** from the drop-down list in the type column
3. Fill in the relevant information in the name field (eg:jackey)
4. Add the corresponding phone number in the value (eg: 4343)
5. Select the subtype you want to set in the subtype drop-down (for example: BLF/NEW CALL--indicator prompt/call)
6. You can select the line you want to set in the line out. The default is AUTO automatic selection (the indicator will not light up initially when AUTO is selected, and it will light up only after the corresponding line is selected)
7. Finally choose **【Submit】**

Key	Type	Name	Value	Subtype	Line	Media	PickUp Number
F 1	Memory Key		1	BLF/NEW CAL	SIP1	DEFAULT	
F 2	None			None	AUTO	DEFAULT	
F 3	None			None	AUTO	DEFAULT	
F 4	None			None	AUTO	DEFAULT	
F 5	None			None	AUTO	DEFAULT	
F 6	None			None	AUTO	DEFAULT	
F 7	None			None	AUTO	DEFAULT	
F 8	None			None	AUTO	DEFAULT	
F 9	None			None	AUTO	DEFAULT	
F 10	None			None	AUTO	DEFAULT	
F 11	None			None	AUTO	DEFAULT	
F 12	None			None	AUTO	DEFAULT	
F 13	None			None	AUTO	DEFAULT	
F 14	None			None	AUTO	DEFAULT	
F 15	None			None	AUTO	DEFAULT	
F 16	None			None	AUTO	DEFAULT	
F 17	None			None	AUTO	DEFAULT	
F 18	None			None	AUTO	DEFAULT	
F 19	None			None	AUTO	DEFAULT	
F 20	None			None	AUTO	DEFAULT	

Picture 13 - EXT Key (2)

7.2.3 Line Configurations

The following steps are required:

1. Select **【Function key】** >> **【EXT Key】**
2. Select **【Line】** in the type column drop-down
3. Fill in the relevant information in the name column (eg: jackey)
4. Select the subtype you want to set in the subtype drop-down (for example: BLF/NEW CALL--indicator prompt/call)

5. You can select the line you want to set in the line out. The default is AUTO automatic selection (the indicator will not light up initially when AUTO is selected, and it will light up only after the corresponding line is selected)

6. Finally choose **【Submit】**

Picture 14 - EXT Key (3)

7.2.4 Key Event Configurations

The following steps are required:

1. Select **【Function key】** >> **【EXT Key】**
2. Select **【Key Event】** in the type column drop-down
3. Fill in the relevant information in the name field (eg:jackey)
4. Select the sub-type you want to set in the sub-type drop-down list (eg:Do-not-disturb/MWI/Hold Call...)
5. Finally choose **【Submit】**

Key	Type	Name	Value	Subtype	Line	Media	PickUp Number
F 1	Key Event		1	None	SIP1	DEFAULT	
F 2	None			None	AUTO	DEFAULT	
F 3	None			None	AUTO	DEFAULT	
F 4	None			None	AUTO	DEFAULT	
F 5	None			None	AUTO	DEFAULT	
F 6	None			None	AUTO	DEFAULT	
F 7	None			None	AUTO	DEFAULT	
F 8	None			None	AUTO	DEFAULT	
F 9	None			None	AUTO	DEFAULT	
F 10	None			None	AUTO	DEFAULT	
F 11	None			None	AUTO	DEFAULT	
F 12	None			None	AUTO	DEFAULT	
F 13	None			None	AUTO	DEFAULT	
F 14	None			None	AUTO	DEFAULT	
F 15	None			None	AUTO	DEFAULT	
F 16	None			None	AUTO	DEFAULT	
F 17	None			None	AUTO	DEFAULT	
F 18	None			None	AUTO	DEFAULT	
F 19	None			None	AUTO	DEFAULT	
F 20	None			None	AUTO	DEFAULT	

Picture 15 - EXT Key (4)

7.2.5 DTMF Configurations

The following steps are required:

1. Select **Function key** >> **EXT Key**
2. Select **DTMF** in the type column drop-down
3. Fill in the relevant information in the name field (eg:jackey)
4. Add the corresponding phone number in the value (eg: 123456)
5. Finally choose **Submit**

Key	Type	Name	Value	Subtype	Line	Media	PickUp Number
F 1	DTMF		1	None	SIP1	DEFAULT	
F 2	None			None	AUTO	DEFAULT	
F 3	None			None	AUTO	DEFAULT	
F 4	None			None	AUTO	DEFAULT	
F 5	None			None	AUTO	DEFAULT	
F 6	None			None	AUTO	DEFAULT	
F 7	None			None	AUTO	DEFAULT	
F 8	None			None	AUTO	DEFAULT	
F 9	None			None	AUTO	DEFAULT	
F 10	None			None	AUTO	DEFAULT	
F 11	None			None	AUTO	DEFAULT	
F 12	None			None	AUTO	DEFAULT	
F 13	None			None	AUTO	DEFAULT	
F 14	None			None	AUTO	DEFAULT	
F 15	None			None	AUTO	DEFAULT	
F 16	None			None	AUTO	DEFAULT	
F 17	None			None	AUTO	DEFAULT	
F 18	None			None	AUTO	DEFAULT	
F 19	None			None	AUTO	DEFAULT	
F 20	None			None	AUTO	DEFAULT	

Picture 16 - EXT Key (5)

7.2.6 URL/Action URL/XML Browser Configurations

The following steps are required:

1. Select **【Function key】** >> **【EXT Key】**
2. Select **【URL】** / **【Action URL】** in the type column
3. Fill in the relevant information in the name field (eg:ldap)
4. Fill in the URL of the relevant configuration in the value (for example: http://192.168.1.1/...)
5. Configure Action URL, select http(s) get /http(s) post in subtype
6. Finally choose **【Submit】**

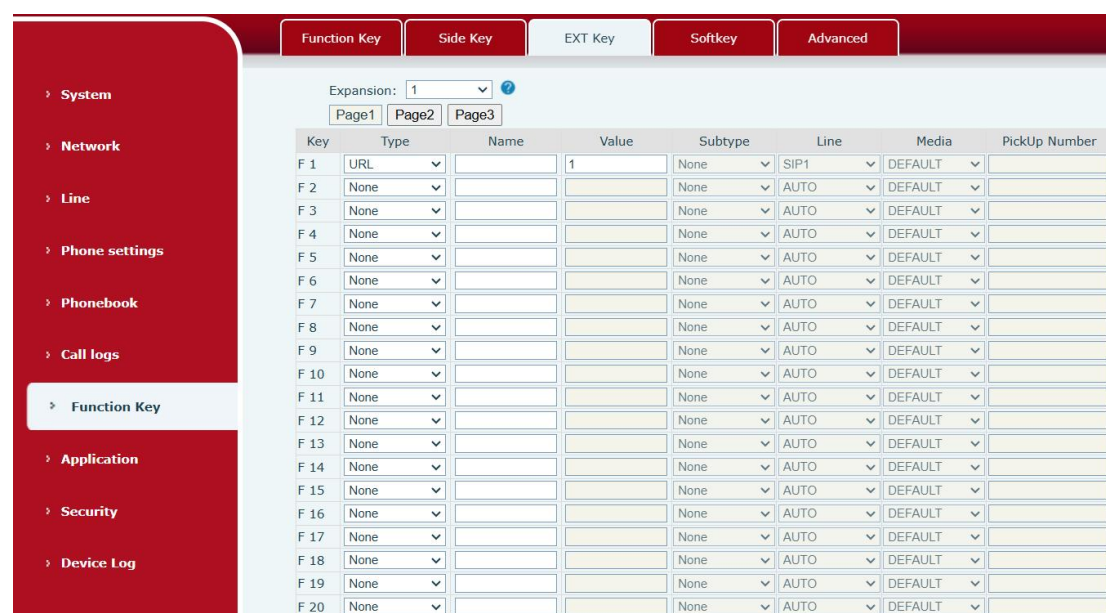

Key	Type	Name	Value	Subtype	Line	Media	PickUp Number
F 1	URL		1	None	SIP1	DEFAULT	
F 2	None			None	AUTO	DEFAULT	
F 3	None			None	AUTO	DEFAULT	
F 4	None			None	AUTO	DEFAULT	
F 5	None			None	AUTO	DEFAULT	
F 6	None			None	AUTO	DEFAULT	
F 7	None			None	AUTO	DEFAULT	
F 8	None			None	AUTO	DEFAULT	
F 9	None			None	AUTO	DEFAULT	
F 10	None			None	AUTO	DEFAULT	
F 11	None			None	AUTO	DEFAULT	
F 12	None			None	AUTO	DEFAULT	
F 13	None			None	AUTO	DEFAULT	
F 14	None			None	AUTO	DEFAULT	
F 15	None			None	AUTO	DEFAULT	
F 16	None			None	AUTO	DEFAULT	
F 17	None			None	AUTO	DEFAULT	
F 18	None			None	AUTO	DEFAULT	
F 19	None			None	AUTO	DEFAULT	
F 20	None			None	AUTO	DEFAULT	

Picture 17 - EXT Key (6)

7.2.7 MCAST Configurations

The following steps are required:

1. Select **【Function key】** >> **【EXT Key】**
2. Select **【MCAST Paging】** in the drop-down list of the type
3. Fill in the relevant information in the name field (eg:jackey)
4. Fill in the relevant configured multicast address and port in the value (eg:239.1.1.4:1371)
5. Select the subtype you want to set in the subtype drop-down (eg:G.711U/G.711A/G.726-16...)
6. Finally choose **【Submit】**

System

Network

Line

Phone settings

Phonebook

Call logs

Function Key

Application

Security

Device Log

Function Key

Side Key

EXT Key

Softkey

Advanced

Expansion: 1

Page1

Page2

Page3

Key	Type	Name	Value	Subtype	Line	Media	PickUp Number
F 1	MCAST Pigin		1	G711U	SIP1	DEFAULT	
F 2	None			None	AUTO	DEFAULT	
F 3	None			None	AUTO	DEFAULT	
F 4	None			None	AUTO	DEFAULT	
F 5	None			None	AUTO	DEFAULT	
F 6	None			None	AUTO	DEFAULT	
F 7	None			None	AUTO	DEFAULT	
F 8	None			None	AUTO	DEFAULT	
F 9	None			None	AUTO	DEFAULT	
F 10	None			None	AUTO	DEFAULT	
F 11	None			None	AUTO	DEFAULT	
F 12	None			None	AUTO	DEFAULT	
F 13	None			None	AUTO	DEFAULT	
F 14	None			None	AUTO	DEFAULT	
F 15	None			None	AUTO	DEFAULT	
F 16	None			None	AUTO	DEFAULT	
F 17	None			None	AUTO	DEFAULT	
F 18	None			None	AUTO	DEFAULT	
F 19	None			None	AUTO	DEFAULT	
F 20	None			None	AUTO	DEFAULT	

Picture 18 - EXT Key (7)

8 Firmware Upgrade

Visit the Function key>>EXT Key page on the web, Under the **【Firmware Upgrade】** module, check the box before the serial number of the expansion unit that needs to be upgraded, click **【Select】** select the firmware of the expansion unit, and click **【Upload】** to upgrade.

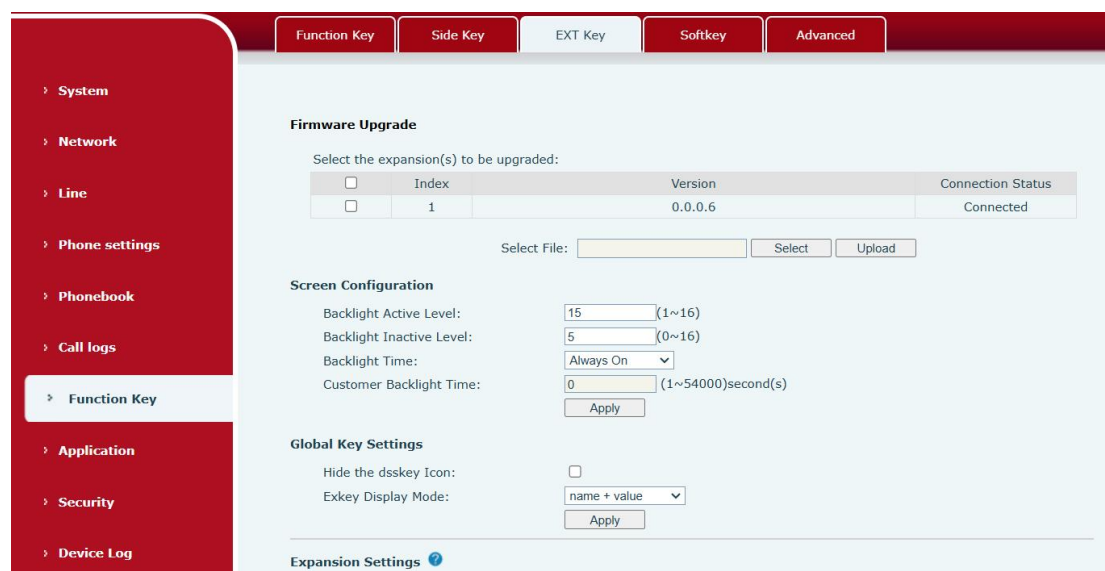

The screenshot shows the Fanvil web interface with the 'Function Key' tab selected. The 'Firmware Upgrade' section is active, displaying a table of expansion units. The first unit has index 1 and version 0.0.0.6, with a 'Connected' status. Below the table, there is a 'Select File' input field and 'Select' and 'Upload' buttons. The 'Screen Configuration' section includes settings for Backlight Active Level (15), Backlight Inactive Level (5), Backlight Time (Always On), and Customer Backlight Time (0). The 'Global Key Settings' section includes 'Hide the dsskey Icon' (unchecked) and 'Exkey Display Mode' (name + value). The 'Expansion Settings' section is partially visible at the bottom.

	Index	Version	Connection Status
<input type="checkbox"/>	1	0.0.0.6	Connected

Select File:

Screen Configuration

Backlight Active Level: (1~16)

Backlight Inactive Level: (0~16)

Backlight Time:

Customer Backlight Time: (1~54000)second(s)

Global Key Settings

Hide the dsskey Icon: ☐

Exkey Display Mode:

Expansion Settings 

Picture 19 - EXT Firmware Upgrade

9 Reboot Phone

Resetting Device to Factory Default will erase all the user's configuration, preference, database and profiles on the device and restore the device back to the state as factory default.

Visit the System>Configurations>Reset Phone page on the web, click the [Reset] button, and the phone and extension station will be restored to factory settings together.

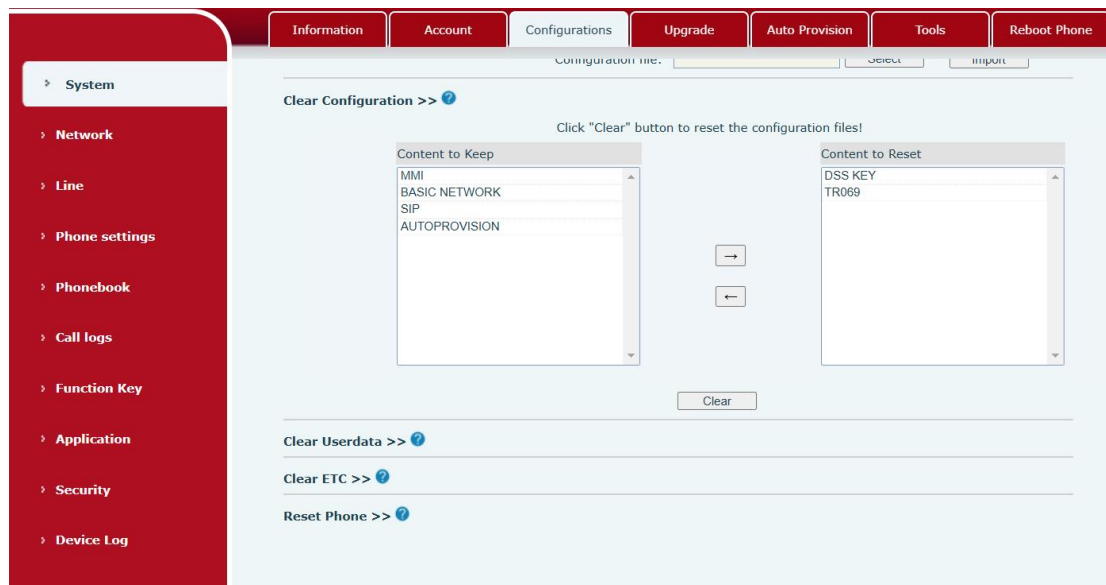

Picture 20 - Reboot Phone

10 Common Trouble Cases

10.1 Device could not boot up

1. Please check whether the power supply of the expansion unit is loose.
2. Confirm that the voltage and current of the provided power adapter meet the specifications of this product.
3. Confirm whether the power cord is damaged.

10.2 Connection failure

1. Please check if the extension station is properly connected to the phone.
2. Please check if the phone is connected to the network.

10.3 Factory Reset

1. When you reset the phone to factory settings, the connected expansion station configuration will also be cleared.